

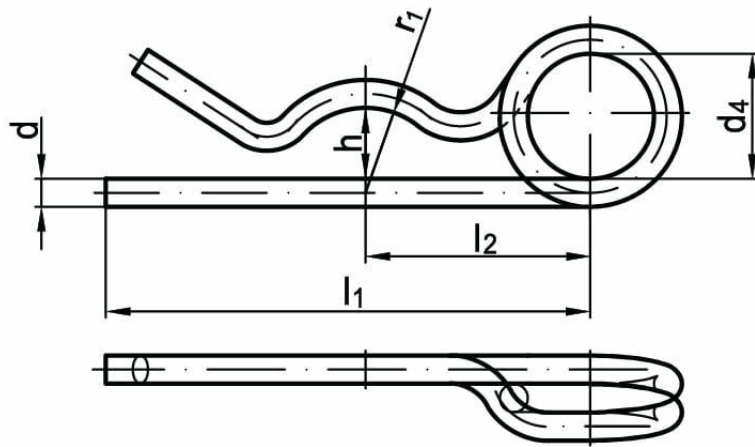

# Cotter pins with double loop DIN 11024

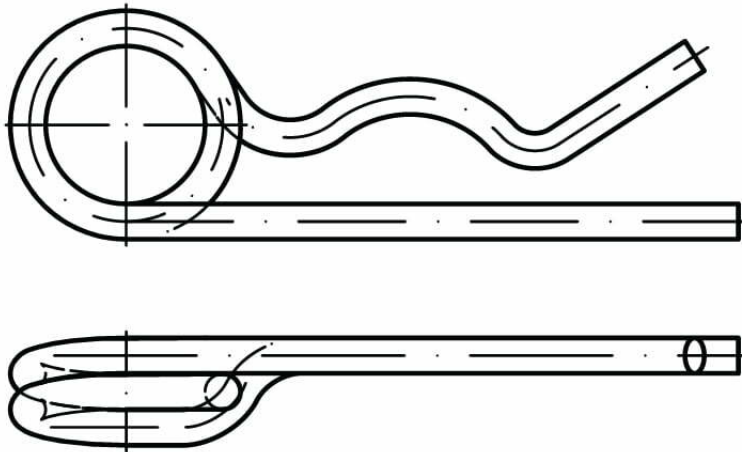

STANDARD	MATERIAL	CLASS	COATING
DIN 11024	steel		galvanized zinc

d	2,5	3,2	4	5	6,3	7	8
d <sub>3</sub>	2,25	2,8	3,6	4,5	5,6	6,3	7
d <sub>4</sub>	20	20	20	25	25	30	30
l <sub>1</sub>	42	48	64	80	97	125	150
l <sub>2</sub>	24	26	32	39	45	56	63
h	2,5	3	4,5	7	9	12,5	17,5
r <sub>1</sub>	5,6	7	10	13	17	22,5	28
&Oslash; pin	9-11,2	11,2-14	14-20	20-26	26-34	34-45	45-56