

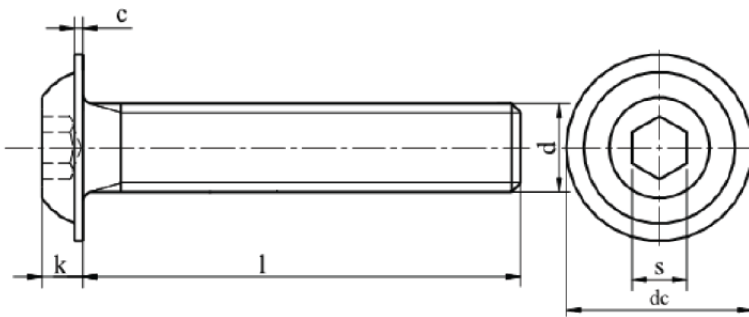

Hex socket button head cap screws with a washer ISO 7380

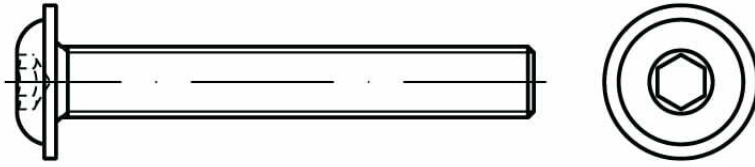

STANDARD	MATERIAL	CLASS	COATING
ISO ~7380	steel A2	8.8 10.9	galvanized zinc

d	M3	M4	M5	M6	M8	M10	M12
dc	6,65	8,85	11,2	13,0	17,1	21,0	23,6
k	1,65	2,2	2,75	3,3	4,4	5,5	6,6
s	2	2,5	3	4	5	6	8